

Introducing your insulin pen device



For more information contact

Sanofi
410 Thames Valley Park Drive
Reading, Berkshire, RG6 1PT

For full safety information and instructions for use, please read the Instructions For Use leaflet in your Toujeo® DoubleStar™ pack.

This item has been developed and funded by Sanofi



Reporting of side effects

If you get any side effects, talk to your doctor, pharmacist or nurse. This includes any possible side effects not listed in the package leaflet.

You can also report side effects directly via the Yellow Card Scheme at yellowcard.mhra.gov.uk or to Sanofi by phoning **0800 0902314**.

By reporting side effects you can help provide more information on the safety of this medicine.

Instructions for use

Please make sure you also read the **Instructions For Use** leaflet provided with your **Toujeo® DoubleStar™** for more information.

Your **Toujeo® DoubleStar™ pen** contains a total of 900 units of insulin glargine (300 units/mL).

Get to know your  **Toujeo® DoubleStar™**
insulin glargine 300units/mL

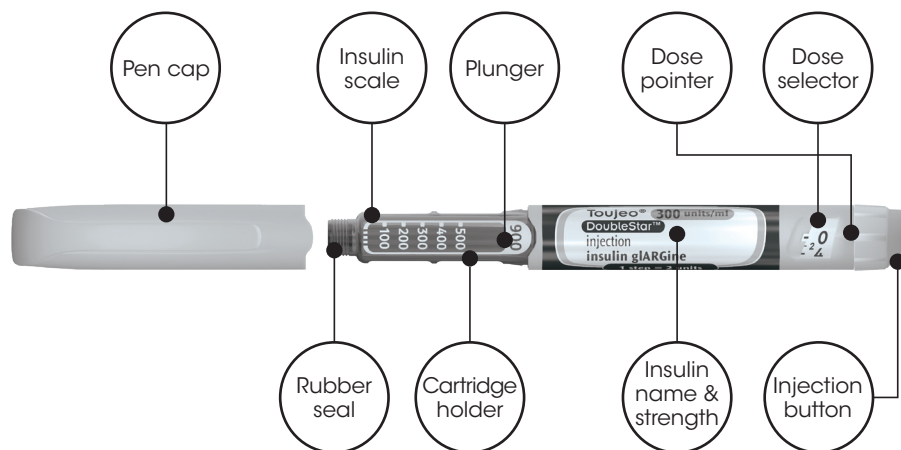

1

Preparing to use your Toujeo® DoubleStar™ pen

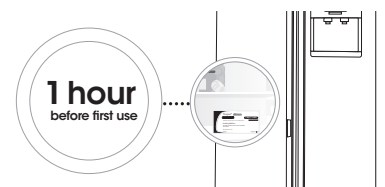

Before using a new pen, take it out of the fridge at least one hour before first use. This will help make the injection more comfortable.

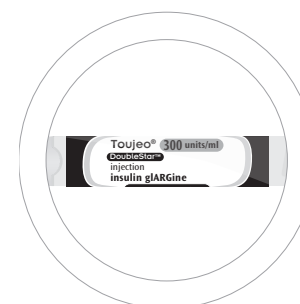

Check you have the right insulin pen. This is very important if you also use other insulin pens.



Check the expiry date has not passed.

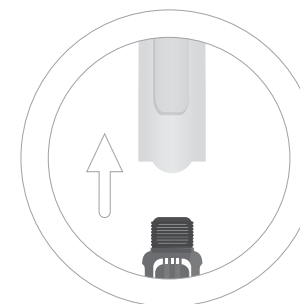

Pull off the pen cap.

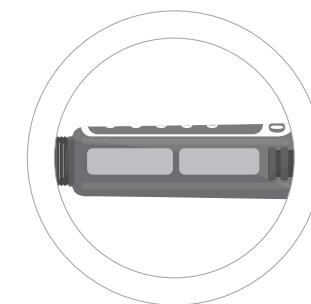

Check that the insulin is clear.



Do not use the pen if the insulin looks cloudy, coloured or contains particles.

2

Attach a new needle

Always use a new sterile needle each time you inject. This helps stop blocked needles, contamination and infection.



Take a new needle and peel off the protective seal.

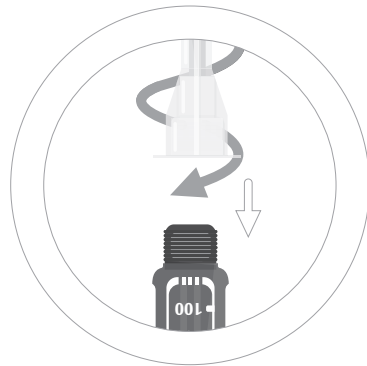

Keep the needle straight and screw it onto the pen until fixed. Do not over tighten.

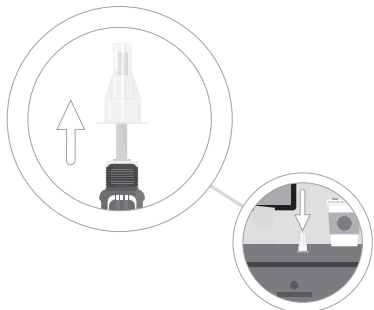

Pull off the outer needle cap and keep it for later.

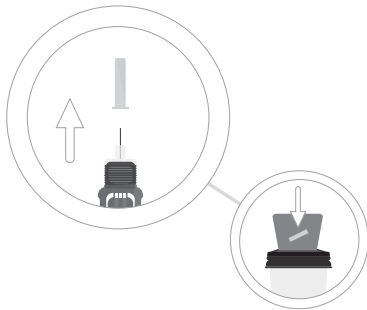

Pull off the inner needle cap and throw it away.



Be careful when you are handling needles to prevent accidental needle-stick injury and risk of infection.

3

Perform a safety test

Always perform a safety test before each injection to ensure your pen and needle are working properly.

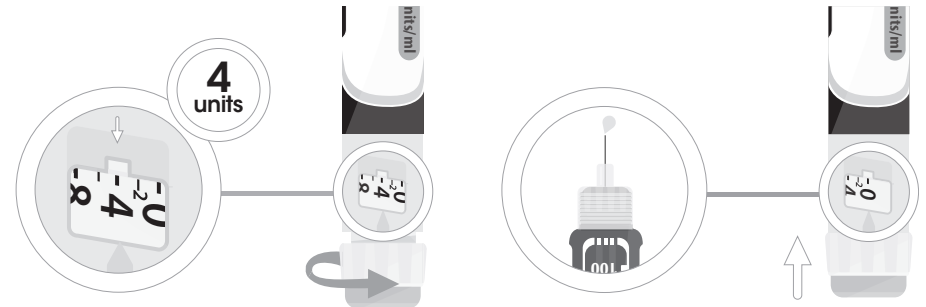

Select a dose of 4 units by turning the dose selector until the dose pointer is at the 4 mark.

Tap the pen cartridge to remove any air bubbles. Do not worry if you still see air bubbles; they are not harmful.

Press the injection button all the way in. When insulin comes out of the needle tip, your pen is working correctly.

If you are using a new pen for the first time, you may need to repeat this step up to six times before seeing insulin.

If no insulin comes out the needle may be blocked. If this happens, change the needle and repeat the safety test.

If after changing the needle you do not see any insulin coming out of the needle tip, do not use the pen. Use a new pen.

Never re-use needles. If you do you might not get your dose (underdosing) or get too much (overdosing) as the needle could block.

Never use a syringe to remove insulin from your pen. If you do you will get too much insulin. The scale on most syringes is made for non-concentrated insulin only.

4 Select your dose

The dose selector of your Toujeo® DoubleStar™ pen dials in 2 unit increments: from 2 to a maximum of 160 units.

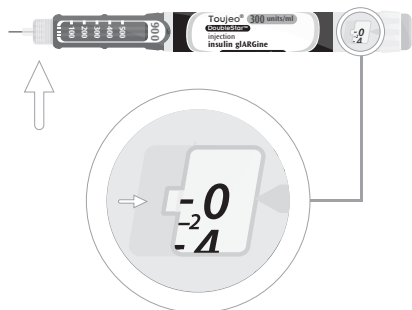

Following the safety test, make sure that the dose is set at 0.

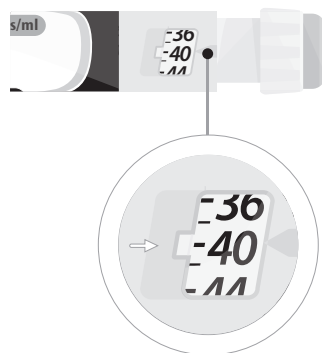

Select your dose by turning the dose selector to a line in the dose window.

If you turn past your dose, you can turn back down.

Each line equals 2 units, so your pen can only dial even doses of insulin.

If there are not enough units left in your pen for your dose, the dose selector will stop at the number of units left. If you cannot select your full prescribed dose, split the dose into two injections or use a new pen.



Do not select a dose or press the injection button without a needle attached. This may damage your pen.

5 Inject your dose

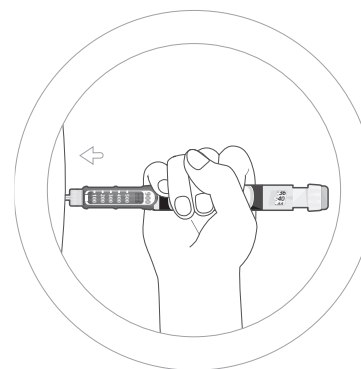

Push the needle into your skin at a 90° angle.

While you are doing so, do not touch the injection button yet.

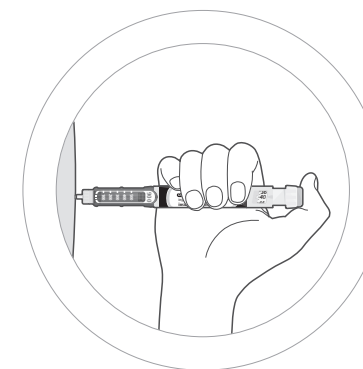

Place your thumb square on the injection button (not at an angle). Then press it in all the way.

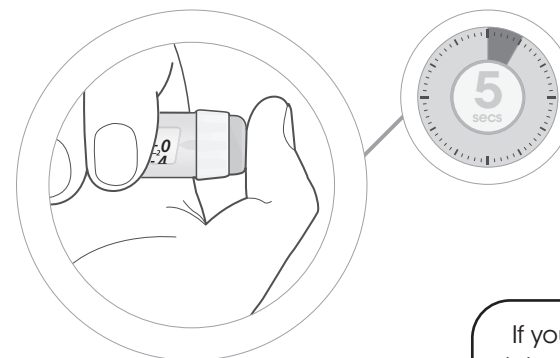

Keep the injection button held in and when you see 0 in the dose window, slowly count to five then remove the needle from your skin.

If you find it hard to press the injection button in, do not use force. Change the needle and do a safety test. If you still find it hard to press in, get a new pen.

6

Remove and dispose of the needle

Remove the needle after every injection. Do not store your Toujeo® DoubleStar™ pen with the needle attached.

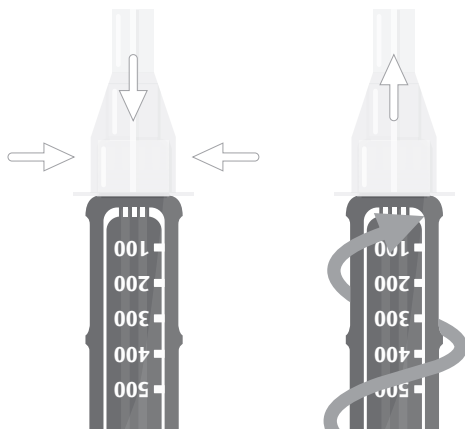

Guide the outer needle cap straight back onto the pen. Turn your pen several times to remove the needle.



Throw away the needle in a puncture resistant container, or as directed by your pharmacist or local authority.

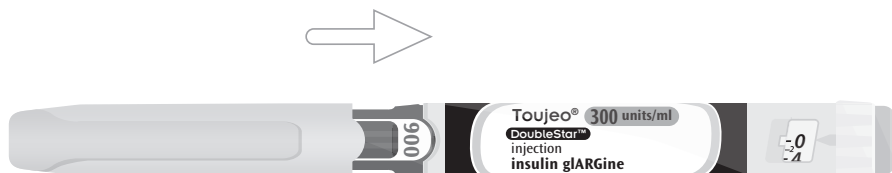

Put the pen cap on and store your Toujeo® DoubleStar™ safely.



Be careful when you are handling needles to prevent accidental needle-stick injury and risk of infection.

Using and storing your pen

Always use needles from BD, Ypsomed, Artsana or Owen Mumford.

Do not use your Toujeo® DoubleStar™ for longer than six weeks after first use.

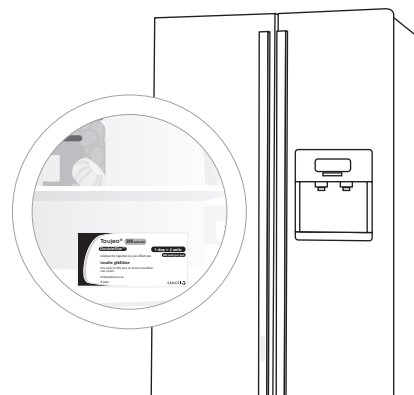

BEFORE first use

Keep your Toujeo® DoubleStar™ in the fridge between 2°C and 8°C.

Do not freeze.

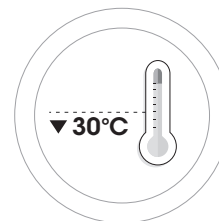

AFTER first use

Keep your Toujeo® DoubleStar™ at room temperature below 30°C.

Do not put your pen back in the fridge.

Store your pen with the cap on. Do not store your pen with a needle attached.

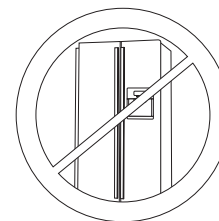

Six simple steps for injecting with your Toujeo® DoubleStar™

1

Prepare your pen



2

Attach a new needle

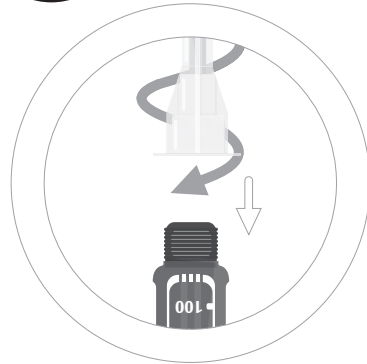

4

Select your dose

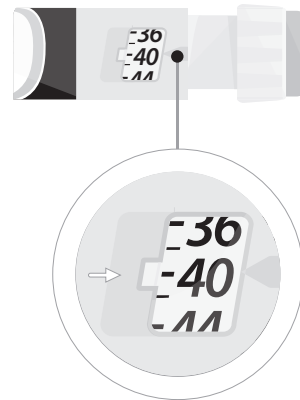

5

Inject your dose

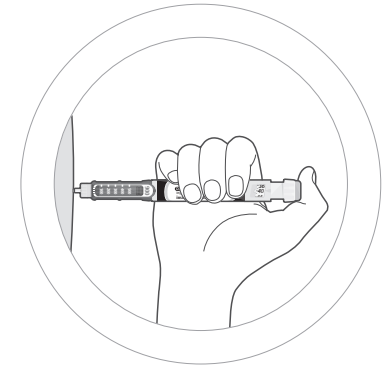

3

Perform a safety test

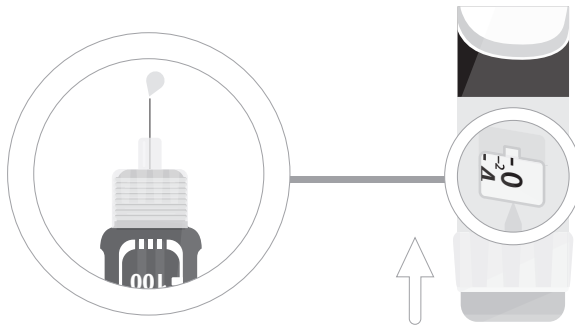

6

Remove and dispose of the needle

